

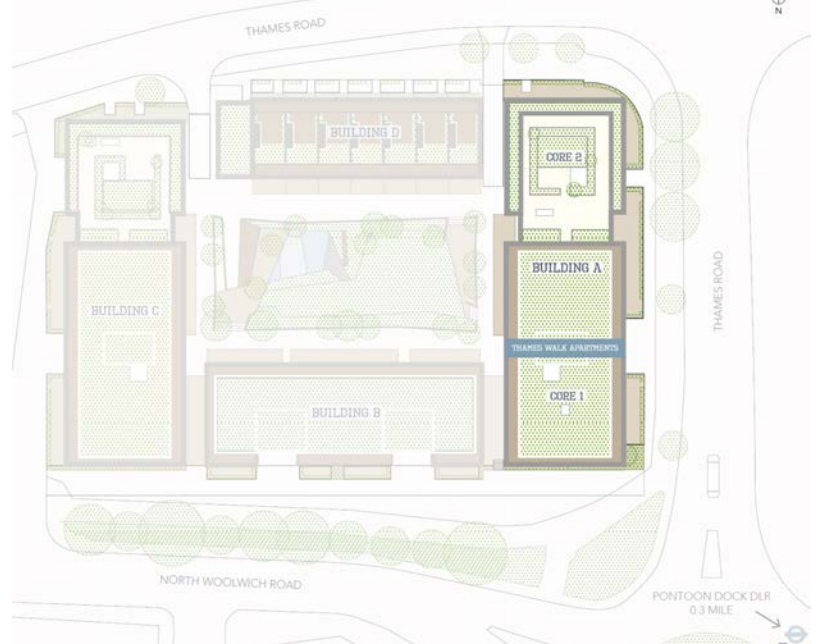

O'HALLORAN & O'BRIEN LTD
BUILDING CONTRACTORS
CIVIL ENGINEERS AND
CONCRETE STRUCTURES

The 1st phase of a new 4 block development with 132 units on this phase only and the associated public open space and landscaping in Royal Docks, London.

- A development of 132 units in the 1st phase with 3 more phases thereafter
- Piled foundations, concrete beams and pile caps, RC Frames, 2 cores.
- Up to 12 stories tall concrete frame
- 4 blocks overall in the scheme
- Domestic Drainage
- Infrastructure and services.



Client:
Redrow
Silvertown, Royal Docks
E16

