

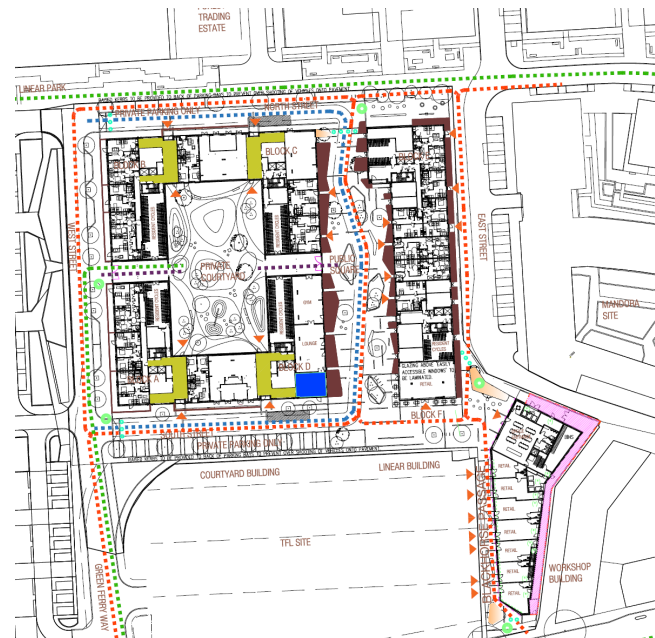

O'HALLORAN & O'BRIEN LTD
BUILDING CONTRACTORS
CIVIL ENGINEERS AND
CONCRETE STRUCTURES

The construction of 5 blocks of flats and a commercial unit, comprising of housing association and private to a total of 337 units. Building Control approval will be carried out by NHBC.

- A development of 337 units and a commercial unit
- Contiguous flight auger piles, Piled foundations, concrete beams and pile caps, RC Frames, cores.
- Contaminated ground remediation
- 5 concrete frames, 9 floors in each
- HDPE Drainage
- Infrastructure and services.



Client:
Telford Homes
158 Equipment Works,
Walthamstow

www.ohob.com